

Parent Drop off and Pick Up

The safety of our students is the most important goal during morning drop-off and afternoon pick-up. To maintain safety during parent drop-off and pick-up, please review the following to ensure our students safely enter and exit Minetto Elementary.

We all have a responsibility to see that every child is safe. In addition, we need to keep traffic moving to facilitate student arrival and dismissal in a timely manner. Student safety during the morning drop-off and afternoon pick-up is of the utmost importance.

If you are driving your child to and from school, please **use Community Drive to enter the drop off or pick up circle. All cars will exit the parking lot using Meeker Avenue.** This will allow a 1-way system and ease problems caused by 2 cars trying to enter our small parking lot area.

The picture below shows the traffic flow that we will be using in the morning and afternoon.

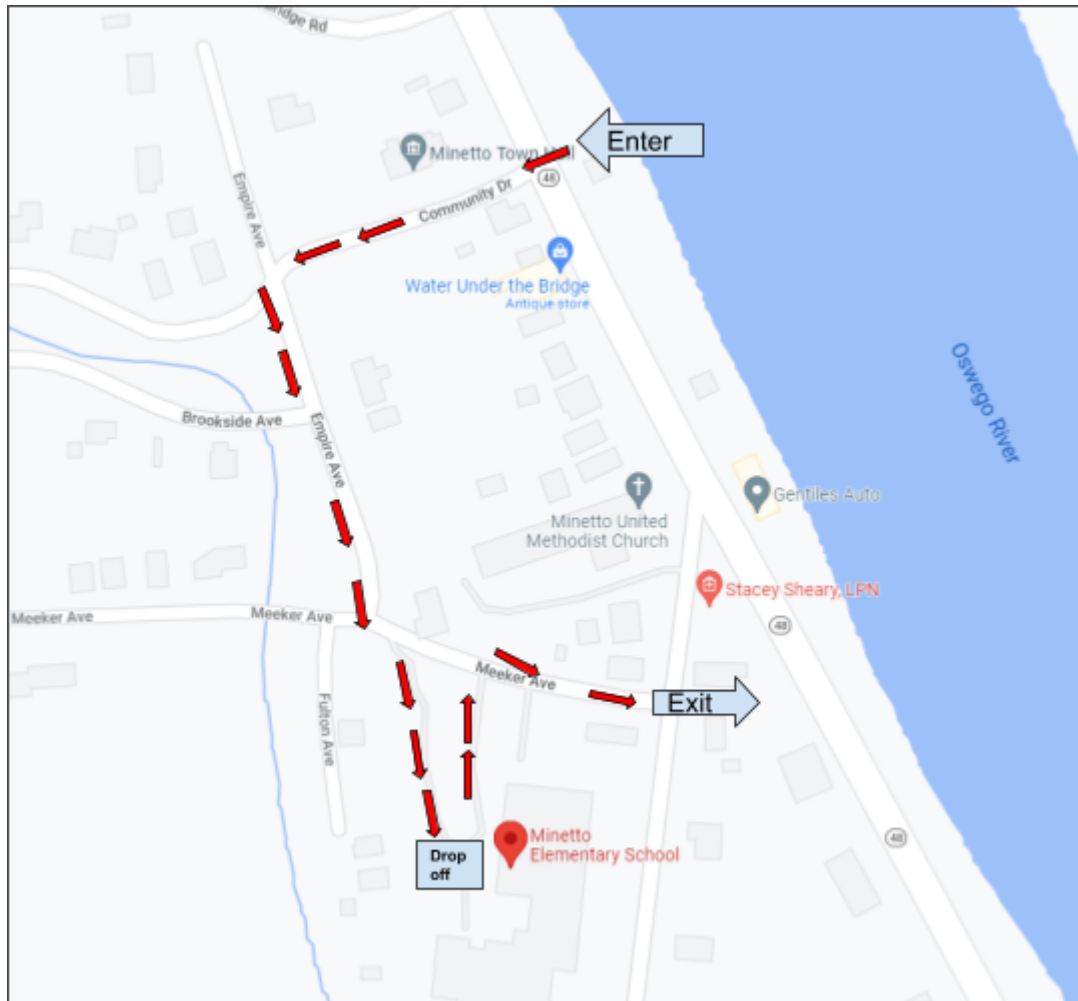

Once you arrive in the parking lot, there are 2 options for dropping off or picking up your child.

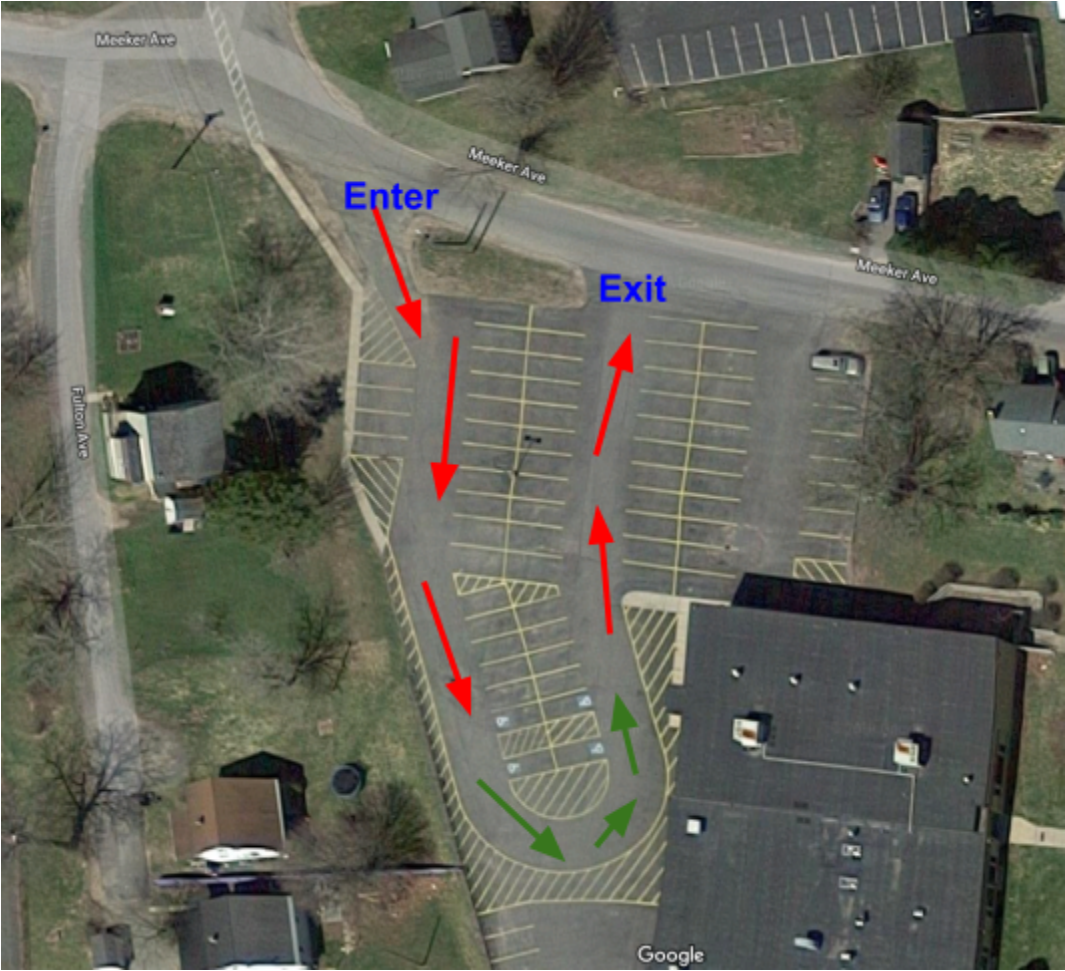

**Parent Drop Off/Pick Up
Two options for Arrivals and Dismissals**

Stop and Drop (Green Zone)	Park and walk
<ul style="list-style-type: none"> ● Adult stays in the car and use the green zone of the “loop” ● Children exit or enter the car, from the passenger side, on their own ● Traffic continues to move 	<ul style="list-style-type: none"> ● Park in a parking space ● Use the yellow lined area to walk with your child to or from the main entrance ● Wait patiently on the sidewalk area

Thank you for your assistance in helping us maintain a safe parking lot.

Sincerely,
Mrs. Sullivan